



2007 PLAYMAKERS

NOTES:

- 1) This play system design will meet the ADA Accessibility Guidelines for Buildings and Facilities, effective November 17, 2000, as published by the Architectural and Transportation Barriers Compliance Board, when installed over accessible surfacing, based on the following criteria:
 - a.) An accessible route must be provided to the play area.
 - b.) Of the 15 elevated play activities, 8 must be along an accessible route.
 - c.) 13 elevated play activities are accessible by transfer station.
 - d.) 5 activities of 3 types of ground level play must be provided, as required by I.A.W. document "36 CFR Part 1191", Table 15.6.2.2.
 - e.) 8 activities of 6 types of ground level play are provided.
 - f.) At least one of each type of ground level play activity must be along an accessible route.
- 2) This site plan should be checked against the actual site area prior to the purchase or installation of equipment.
- 3) Kick plates must be installed between 12" deck increments.
- 4) The unit of measure located in the center of the platform indicates the height above the protective surfacing level. The protective surfacing for this design must accommodate a fall height of at least 8 Ft.
- 5) The structure size for this unit is 352" x 579" x 11" requiring protective surfacing for an overall use zone of 555" x 1076". The approximate surface area is 4113 Sq. Ft., as required by ASTM F1487-05 guidelines.
- 6) This structure is designed to accommodate 81 children from 5 to 12 years of age.
- 7) Supervise children as they play.
- 8) To ensure that accurate measurements are obtained from this drawing, print copies on 11 x 17 paper at full scale.
- 9) This design configuration is the property of this firm and Playworld Systems® and may not be reproduced or used in any manner without the expressed written consent of this firm and Playworld Systems®.

PROJECT NO: 073017.PLS	REV: A	DATE: 23-JUNE-07
STRUCTURE SIZE (L x W x H) 352" x 579" x 11"		SCALE: 3/32" = 1'-0"
SITE PLAN		DRAWN BY: PATRICK SMITH

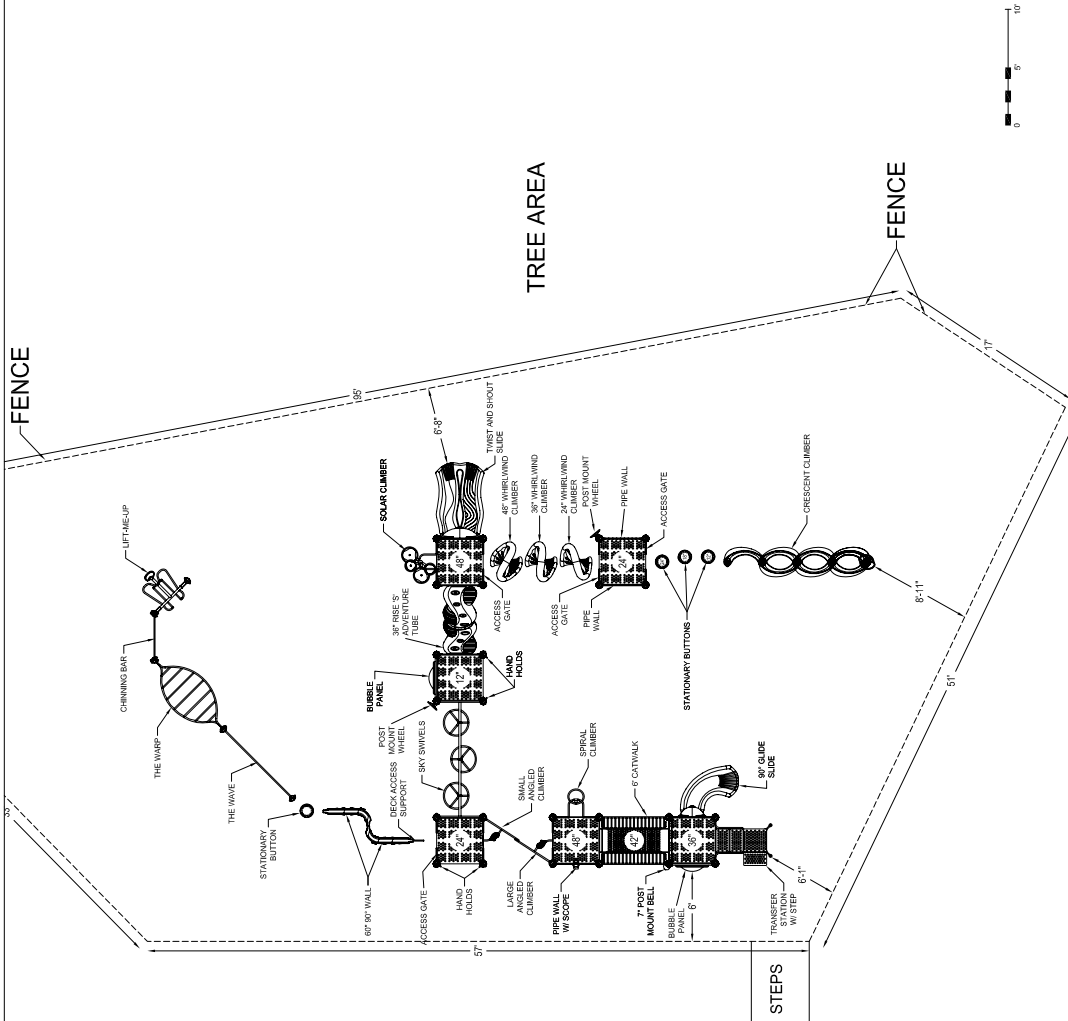

PLAYWORLD™

© 2007 Playworld Systems, Inc.
Playworld is a brand of Playworld Systems, Inc.

ROSEMARY HILLS ES

UPPER UNIT

PLAYGROUND SPECIALISTS, INC.
17352 North Seton Ave.
Emmitsburg, MD 21727

Rosemary Hills ES – Upper Unit

Playground Specialists Inc.



17352 N. Seton Ave
Emmitsburg, MD 21727

Toll free 800.385.0075
Fax 301.447.3556
Email Playspec@aol.com

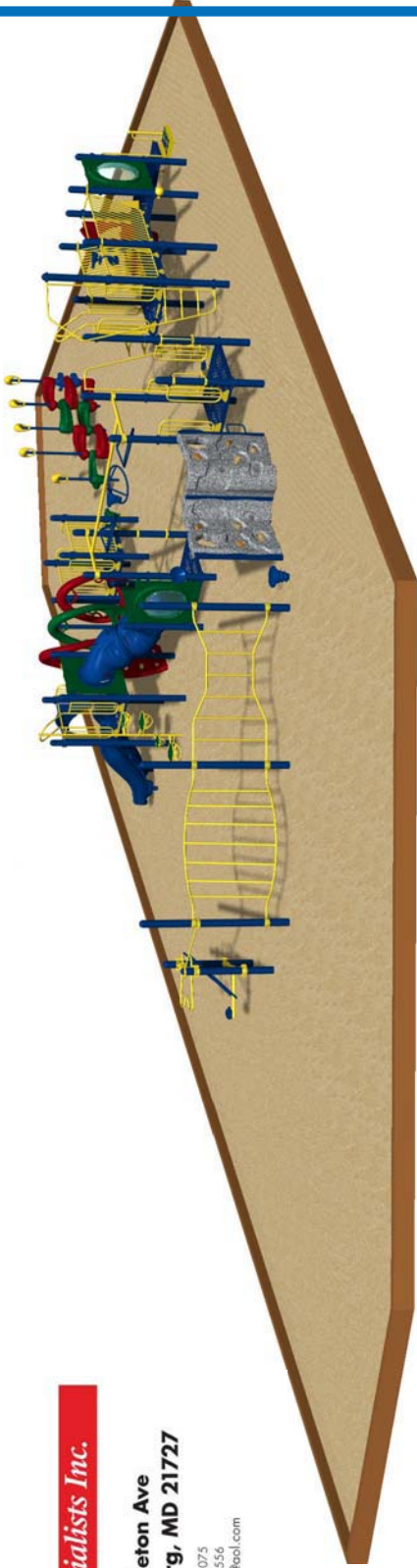

View B ▲

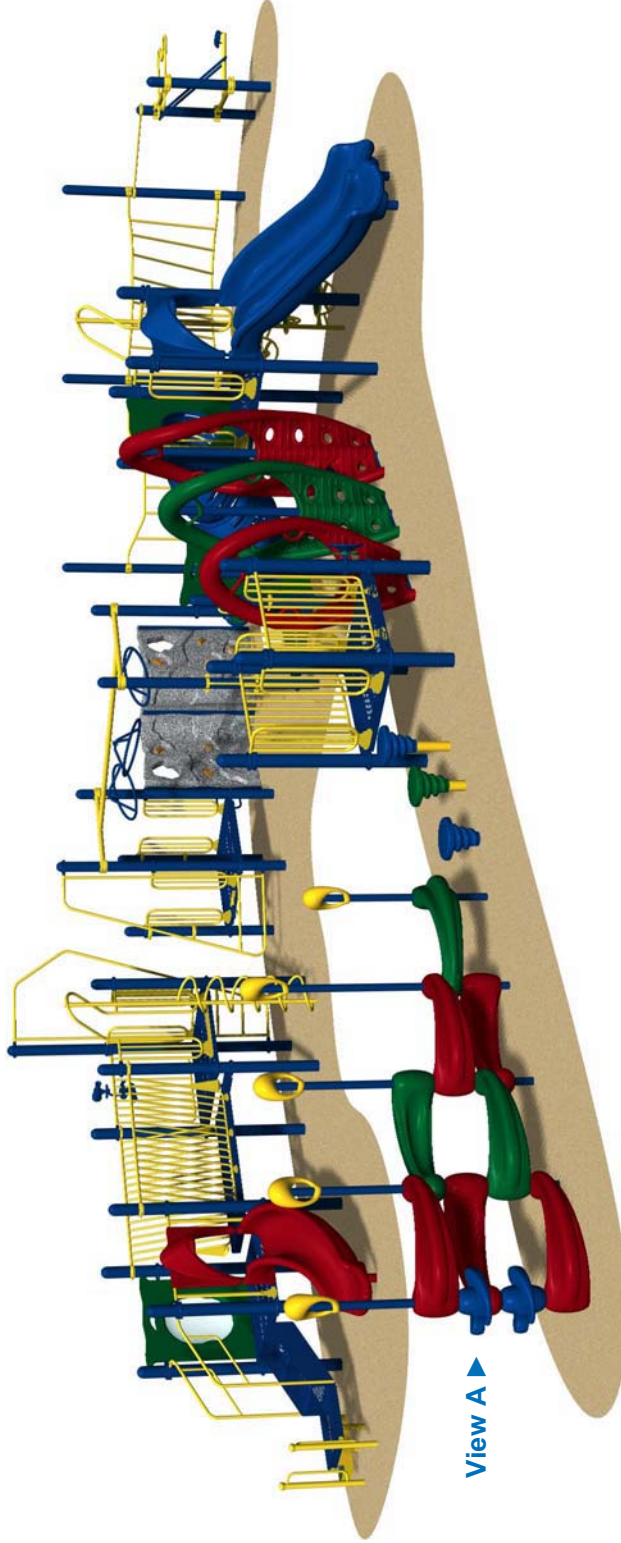

View A ▲



Playmakers® Design
073017A_PLS

Age Group: 5 to 12

Capacity: 86 Children

Play Events: 27 Fun-Filled Events

Structure Size: 35'2" x 57'9" x 11"
(L x W x H)

Use Zone: 55'5" x 107'6"



Colors: Blue, Yellow, Green, Red, Blue, Green, Play Armour™, Greystone

PLAYWORLD™

©2007 Playworld Systems, Inc.
Playworld™ is a brand of Playworld Systems®, Inc.